

FIRECAST

Pro. 24

Boom Arm

INSTRUCTION MANUAL
ADXMCARM24



ADXC 

Contents

Safety Warnings.....	2
Unpacking.....	3
Installation.....	4
Installing pop filter (optional).....	7
Specifications.....	7

Safety Warnings

Damage

- Please inspect the unit for damage after unpacking.
- Do not continue to operate the unit if you are in any doubt about it working normally, or if it is damaged in any way.

Temperature

- Avoid extreme degrees of temperature, either hot or cold. Place the unit well away from heat sources such as radiators or gas / electric fires.
- Avoid exposure to direct sunlight and other sources of heat.

Naked Flames

- Never place any type of candle or naked flame on the top of or near the unit.

Interference

- Do not place the unit on or near appliances which may cause electromagnetic interference. If you do, it may adversely affect the working performance of the unit, and cause a distorted sound.

Thank you for purchasing your new product.

We recommend that you spend some time reading this instruction manual in order that you fully understand all the operational features it offers. You will also find some hints and tips to help you resolve any issues.

Read all the safety instructions carefully before use and keep this instruction manual for future reference.

Unpacking

Remove all items from the packaging. Retain the packaging. If you dispose of it please do so according to local regulations.

The following items are included:

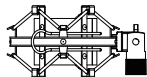

Shock Mount

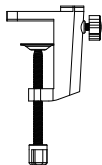
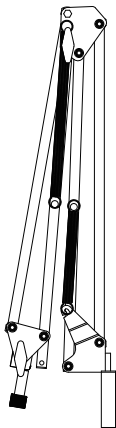
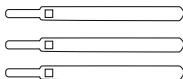

Table Clamp Mount



Adjustable Arm



Velcro × 3 (for securing USB cable (not included) on the boom arm)

Installation

1. Fix the **table clamp mount** on the edge of the table.

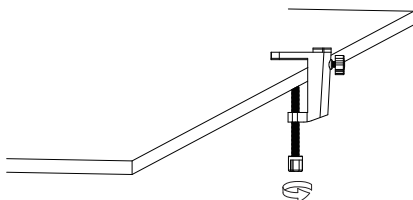

2. Insert the **adjustable arm** into the table clamp mount and then tighten it.

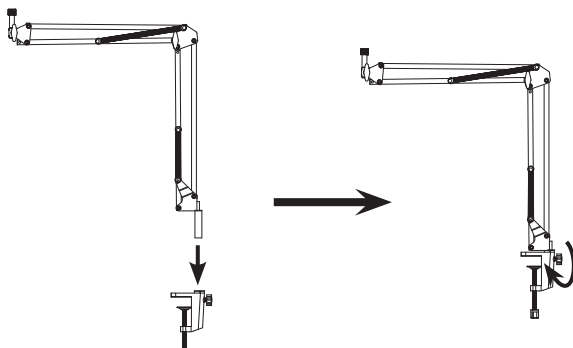

3. Secure the **shock mount** into the other end of the adjustable arm.

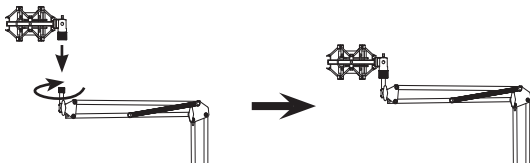

4. Press the clip of the shock mount and then place the **ADXMIC24** microphone (not included) onto it.

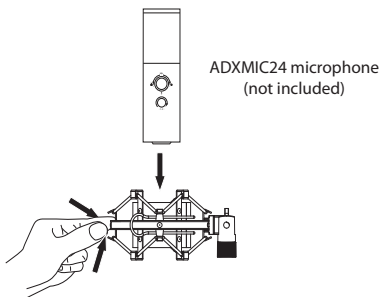



NEVER extend the boom arm more than 90° after it is in a reversed position.

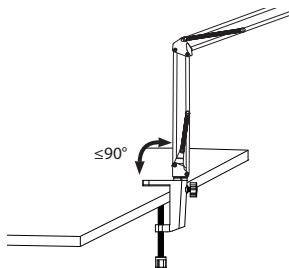
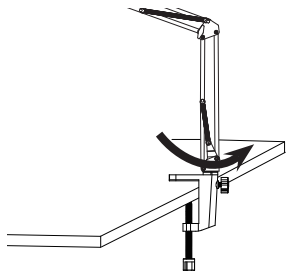

Installing pop filter (optional)

Install **ADXPFLT24** Pop Filter (not included) onto the Boom Arm. Turn the knob of the pop filter to secure the unit.

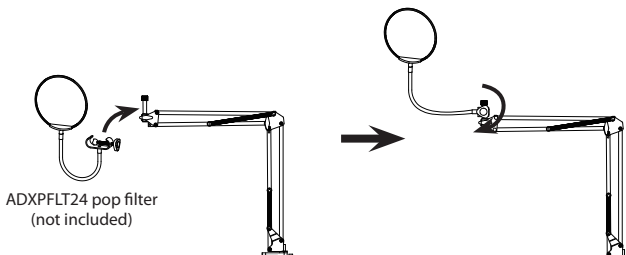

Specifications

Model	ADXMCARM24
Dimension	370 × 395 mm (Arm stand)
Maximum Table thickness (for clamp mounting)	50 mm
Weight	333g (Arm stand) 113g (Clamp Mount)

Features and specifications are subject to change without prior notice.

Currys.co.uk

All the support you need.

Whether it's a tech emergency or you need plain good advice, we're always on hand to help.

UK: 0344 561 1234

IRE: 0818 810575

Partmaster
co.uk

Visit Partmaster.co.uk today for the easiest way to buy electrical spares and accessories.

With over 1 million spares and accessories available we can deliver direct to your door the very next day. Visit www.partmaster.co.uk or call **0344 800 3456** (UK customers only). Calls charged at National Rate.



The symbol on the product or its packaging indicates that this product must not be disposed of with your other household waste. Instead, it is your responsibility to dispose of your waste equipment by handing it over to a designated collection point for the recycling of waste electrical and electronic equipment. The separate collection and recycling of your waste equipment at the time of disposal will help conserve natural resources and ensure that it is recycled in a manner that protects human health and the environment.

For more information about where you can drop off your waste for recycling, please contact your local authority, or where you purchased your product.

Currys Group Limited (co. no. 504877)
1 Portal Way, London, W3 6RS, UK

EU Representative

Currys Ireland Limited (259460)
3rd Floor Office Suite
Omni Park SC, Santry, Dublin 9, Republic of Ireland